

M25 junction 10/A3 Wisley interchange

TR010030

9.30 Key Legend for all Engineering Drawings (reference 1.1.9 ExQ1)

Rule 8(1)(b)

Planning Act 2008

Infrastructure Planning (Examination Procedure) Rules 2010

Volume 9

December 2019

Infrastructure Planning

Planning Act 2008

The Infrastructure Planning (Examination Procedure) Rules 2010

M25 junction 10/A3 Wisley interchange Development Consent Order 202[x]

9.30 Key Legend for all Engineering Drawings (reference 1.1.9 ExQ1)

Rule Number:	Rule 8(1)(c)(i)
Planning Inspectorate Scheme Reference	TR010030
Application Document Reference	TR010030/9.30
Author:	M25 junction 10/A3 Wisley interchange project team, Highways England and Atkins

Version	Date	Status of Version
Rev 0	18 December 2019	Deadline 2

DO NOT SCALE

100
Millimetres

HIGHWAYS

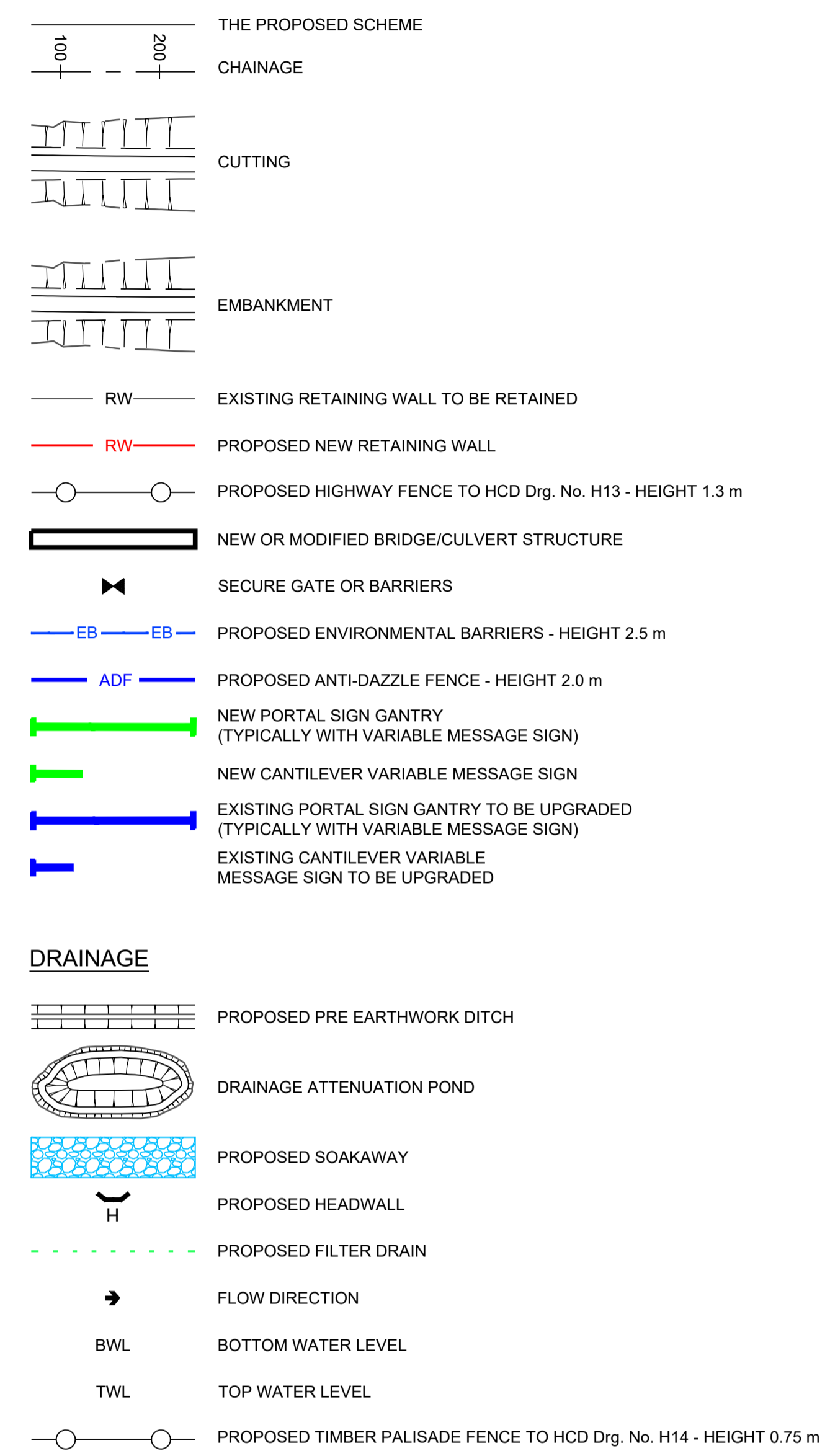

BOUNDARIES



GANTRY SCHEMATICS

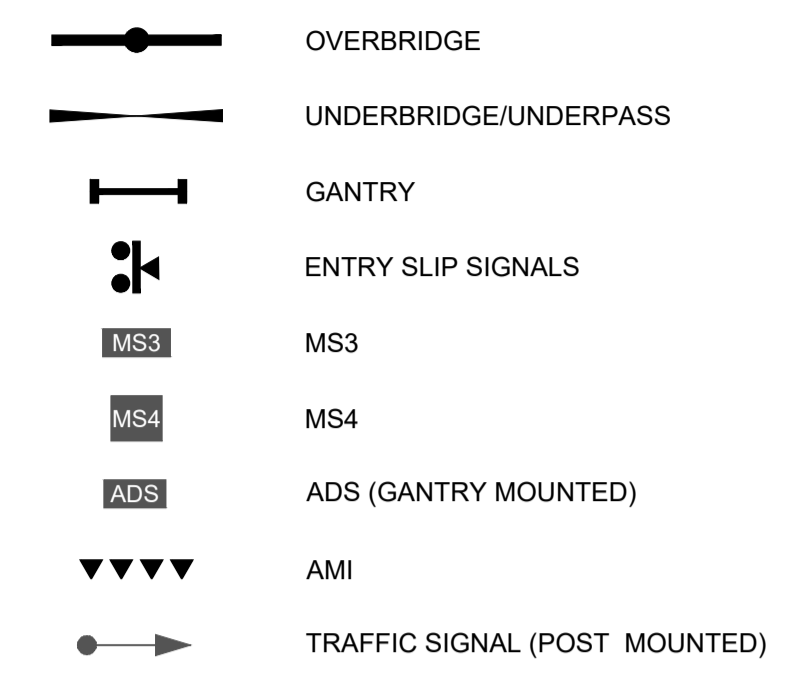

COLOUR KEY

CYAN: EXISTING UPGRADED
BLUE: EXISTING RETAINED/ASSESSED
RED: EXISTING TO BE REMOVED
GREEN: PROPOSED/NEW

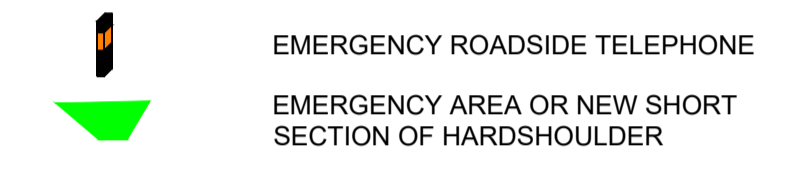

PROFILE ELEMENTS

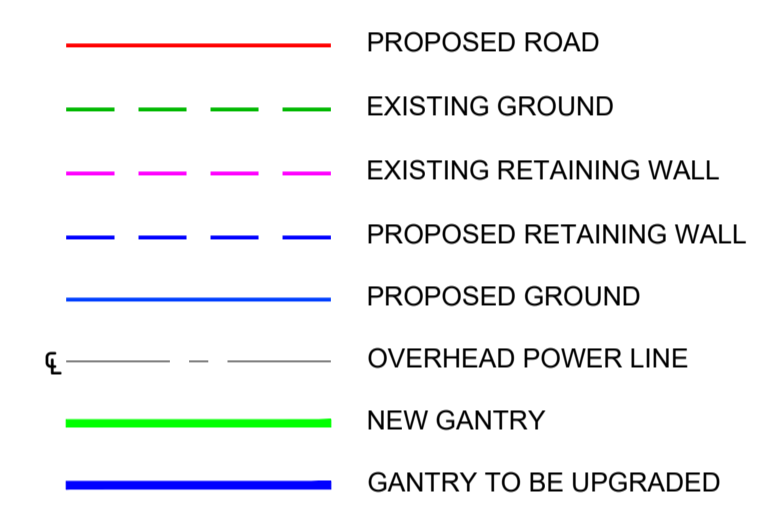

CROSS-SECTION ELEMENTS:

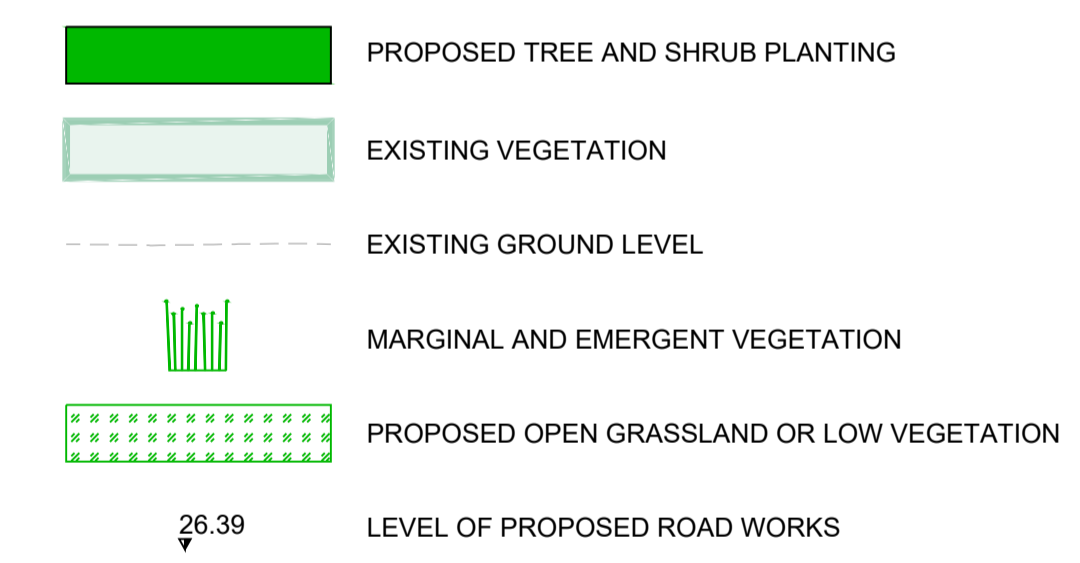

Description							Drawing Suitability	WORK IN PROGRESS	Status	S0	Project Title	M25 junction 10/A3 Wisley interchange
Status	Revision	Drawn	Checked	Reviewed	Authorised	Issue Date	Epsom Gateway Ashley Avenue Epsom Surrey KT18 5AL Tel: +44 (0)1372 726140 Fax: +44 (0)1372 740055 www.atkinsglobal.com		Drawing Title ENGINEERING DRAWINGS AND SECTIONS REGULATION 5(2)(o) KEY LEGEND			
Description							Copyright © Atkins Limited (2018)		Client		Drawing Number TR010030/APP/2.9 HE PIN: HE551522 Scale: NTS Original Size: A1	
Description							Response to ExA Question 1.1.9				Rev: 1	
Status	Revision	Drawn	Checked	Reviewed	Authorised	Issue Date	Response to ExA Question 1.10.1					
A1	0	SA	LH	RM	RB	29/11/19	Response to ExA Question 1.10.1					
S0	1	---	---	---	---	---						

© Crown copyright (2019).

You may re-use this information (not including logos) free of charge in any format or medium, under the terms of the Open Government Licence. To view this licence:

visit www.nationalarchives.gov.uk/doc/open-government-licence/
write to the Information Policy Team, **The National Archives, Kew, London TW9 4DU**,
or email psi@nationalarchives.gsi.gov.uk.

Printed on paper from well-managed forests and other controlled sources.

Registered office Bridge House, 1 Walnut Tree Close, Guildford GU1 4LZ
Highways England Company Limited registered in England and Wales number 09346363